ASSEMBLY INSTRUCTIONS FOR FLOOR STAND

P/Ns: P005300, 5320, 5360

SmartLF Gx 40 & Gx+ 28/42/56

(SCANNER ACCESSORY)



Version 1.6 June 2010



PARTS LIST

Item	Description	Quantity
1	crossbar	1
2	leg upright (L&R handed)	2
3	foot section with wheels (L&R handed)	2
4	top mounts (L&R handed)	2
5	M6x25mm round head hex bolt (crossbar to leg upright)	4
6	M6x16mm socket head bolt (top mount to leg upright)	4
7	M6x16mm round head hex bolt (feet to leg upright)	4
8	M5x40mm socket head bolt (scanner to stand)	4
9	M6 split washers	12
10	M5 split washers	4
11	M5 flat washers	4
12	4mm, 5mm hexagon keys (AF)	2



NOTE: The SmartLF stand is designed to lean BACKWARDS away from the operator. LH and RH mean left-hand and right-hand.



It is recommended that this stand be assembled with the help of an assistant. Always ask someone to help you lift the scanner onto the stand when you have finished assembling it.

PARTS IDENTIFICATION

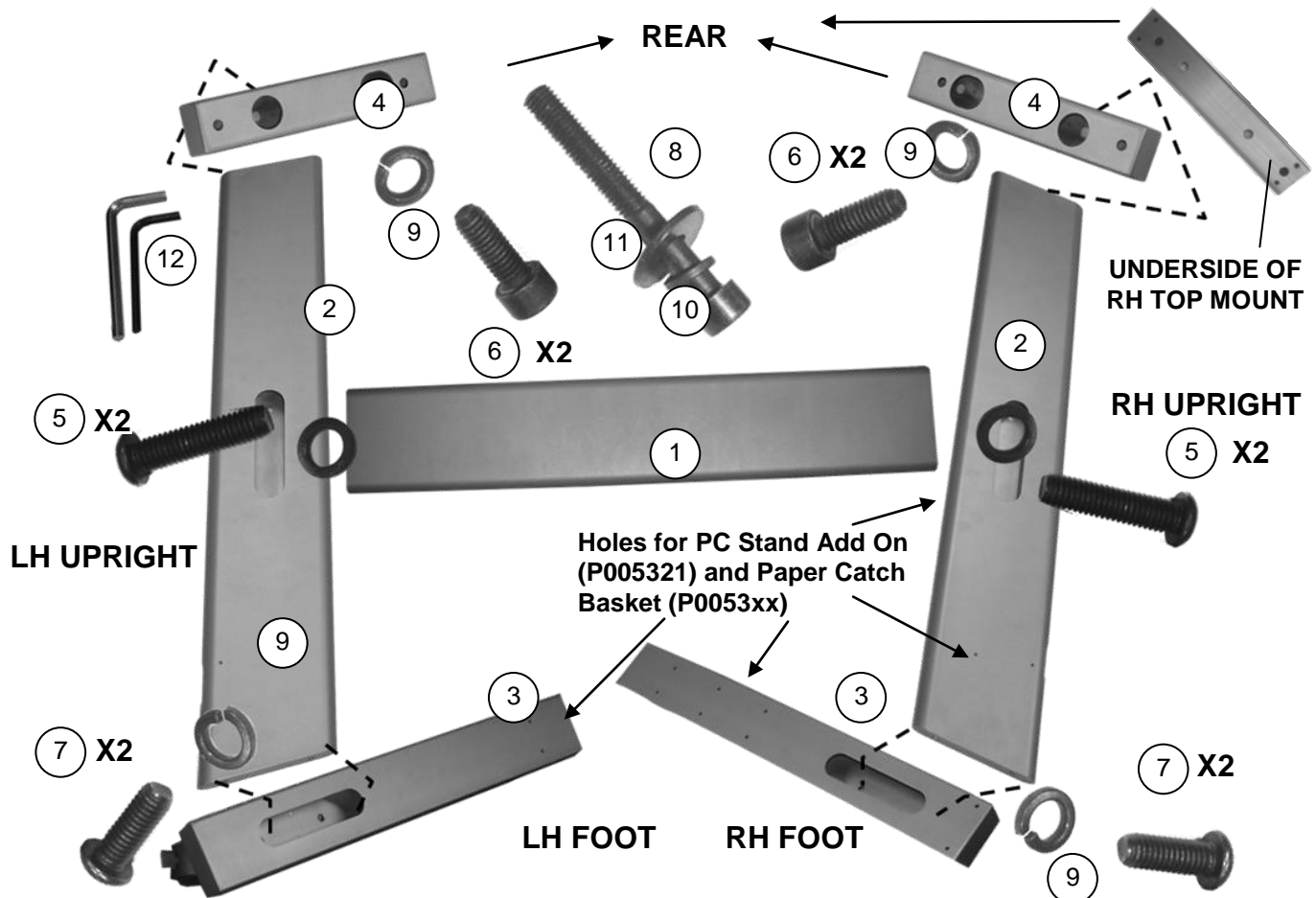

TOP MOUNTS

Attach scanner top mounts (item 4) to leg uprights (item 2) using 4 x socket head bolt (item 6) and 4 x split washer (item 9). Ensure the elongated hole of each top mount faces to rear of stand (shown) and the one with four small holes on the underside is fitted to the RH leg upright. This facilitates attachment of the optional Keyboard and Monitor Add-On kit.

FEET

Attach RH foot section (item 3) to RH leg upright (item 2) using 2 x round head hex bolt (item 7) and 2 x split washer (item 9). Attach LH foot section to LH leg upright in the same way.

CROSSBAR

Attach the crossbar to the completed RH leg assembly using 2 x long round head hex bolt (item 5) and 2 x split washer (item 9). Attach the completed LH leg assembly to the crossbar opposite end in the same way. You may need an assistant to help you.

CHECKING FOR TIGHTNESS

Now check the stand to ensure that all bolts are secure. Do not over-tighten or you may damage the threads.

MOUNTING THE SCANNER

With the help of an assistant lift the scanner by its base (not the end caps) onto the stand observing the location of the four (4) rubber feet and being careful not to trap the fingers. The elongated holes accept the rubber feet at the back of the scanner (scanner appears to lean backwards). Do not release grip on the scanner until you are certain it is correctly placed on the stand.

Blue arrows indicate scanner front. Secure with 4 x socket bolts (item 8) 4 x split washers (item 10) and 4 x flat washers (item 11).



IMPORTANT SAFETY NOTICE

THE SCANNER MUST BE SECURED TO THE FLOOR STAND USING THE FOUR (4) 40MM BOLTS (ITEM 8).

The entire risk of use or the result of use of this hardware or documentation remains with the user. No part of this documentation may be reproduced or transmitted by any means, electronic or mechanical, for any purpose, except with the express prior written permission of Colortrac Ltd.

Colortrac Ltd makes no warranty claims with respect to this documentation and disclaims any implied warranties of merchantability or fitness for a particular purpose. The information contained in this document is subject to change without notice. Colortrac Ltd assumes no responsibility for errors or omissions that may appear in this documentation.

Version 1.6

© Colortrac 2010

Colortrac Ltd.
3-5 Brunel Court
Burrell Road
St. Ives
Cambridgeshire
PE27 3LW
United Kingdom

T: +44 (0) 1480 464618
F: +44 (0) 1480 464620
W: www.colortrac.com

